

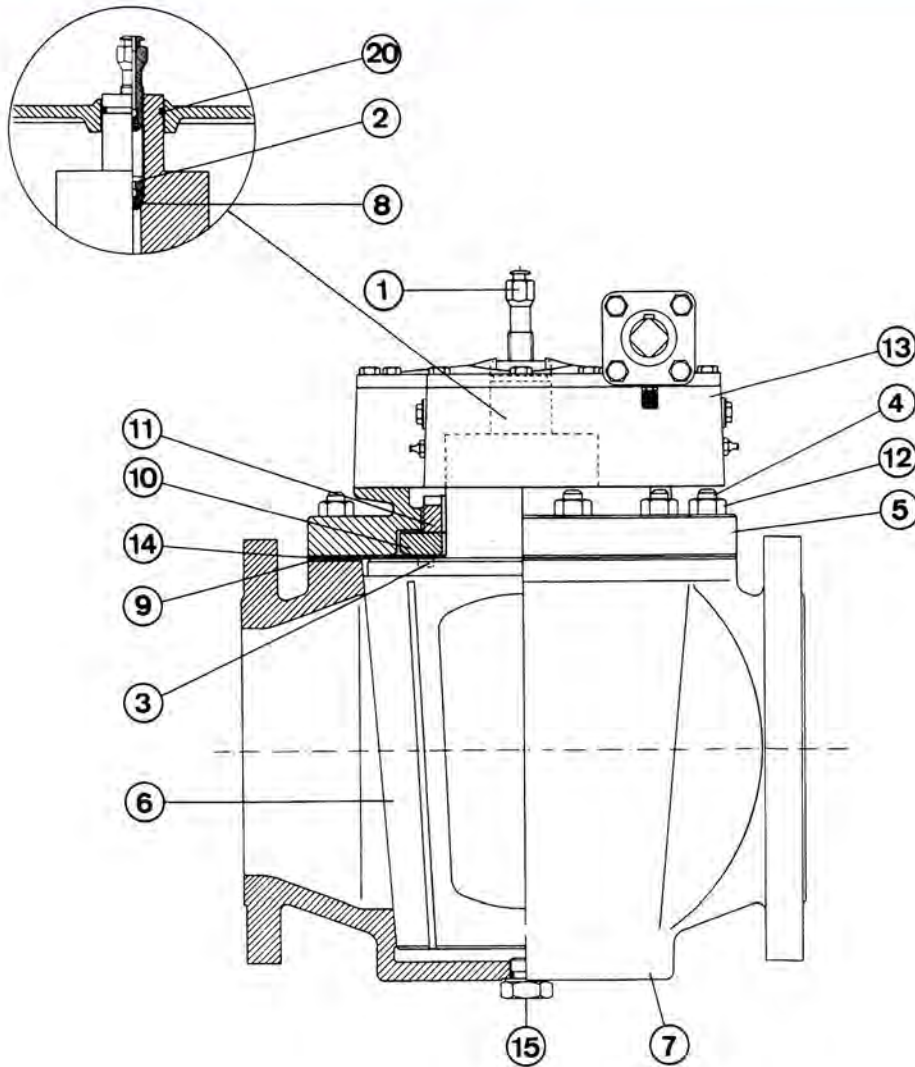

TAPER PLUG VALVES

Valve Construction
Low Pressure Design
Gear Operated Valves



1. Lubricant Screw
2. Check Valve
3. O-Ring
4. Stud
5. Top Cover
6. Taper Plug
7. Body
8. Gasket
9. Gasket
10. Press Ring
11. Adjustable Screw
12. Nut
13. Gearbox
14. Flexible Plate
15. Bottom Screw *
20. O-Ring

Operation – gearing. Gear, type C, is enclosed in a water-proof casing, with the handwheel located vertically on side of the valve.

Gear, type D, is enclosed in a water-proof casing, with the handwheel located horizontally on top of the valve.

Worm and worm wheel are embedded in heavy bronze bearings, and the axial load stress is absorbed by ball bearings. Both bearings and tooth racks are lubricated with concentrated molybdenum grease to resist high temperatures.

The gear has fixed stops at extreme positions, plus position indicator.

Further, all valves can be equipped for automatic cycling using electric, pneumatic or hydraulic actuators.

* On larger valves (above 6") part 15 is utilized as a means of draining Hydrostatic test medium.